

SIENNA TIMBER

MAXIMUM DOOR WEIGHT 120kg

APPLICATIONS

- ▶ Elegant frameless timber door system that creates a minimalist look
- ▶ 120kg system designed for doors of 30-70mm thickness
- ▶ Rollers are engineered to run effortlessly along a brushed stainless steel tubular track
- ▶ Stops are positioned on the track to limit the door travel

DOOR SPECIFICATION

Maximum door panel weight	120kg
Door panel thickness	30 -70mm
Maximum door panel height	2500mm
Minimum door panel width	700mm

GEAR SPECIFICATION

Basic Kit SNI20T	2 hangers, 2 door stops, one guide, 2 bar end caps
Track/brackets	Ø25mm stainless steel tubular track available in standard lengths up to 6m, drilled and pre-assembled with the correct number of wall brackets (details overleaf)
Guide	Floor guide 106N/94
Door Stop	Stop 25/DSR or Stop 25/DSL
Handle	Please contact our technical sales team for details on handles

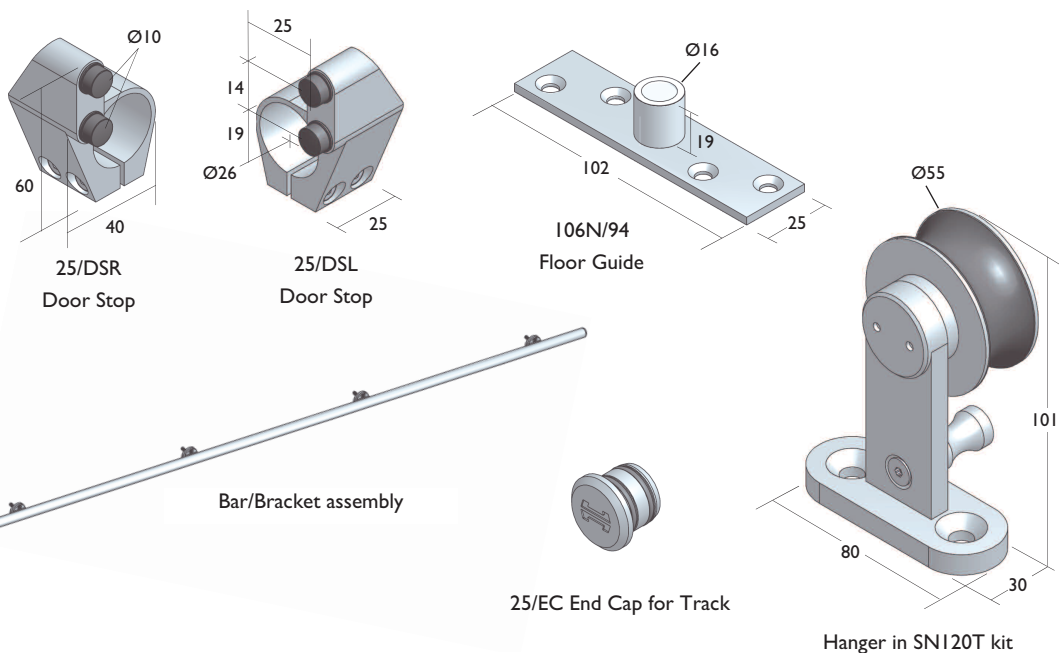
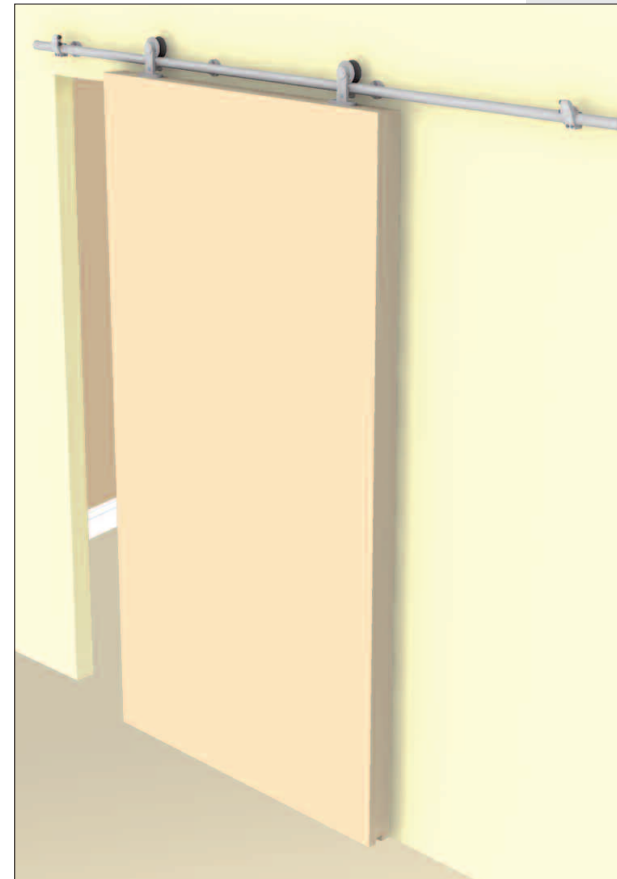

SIENNA TIMBER

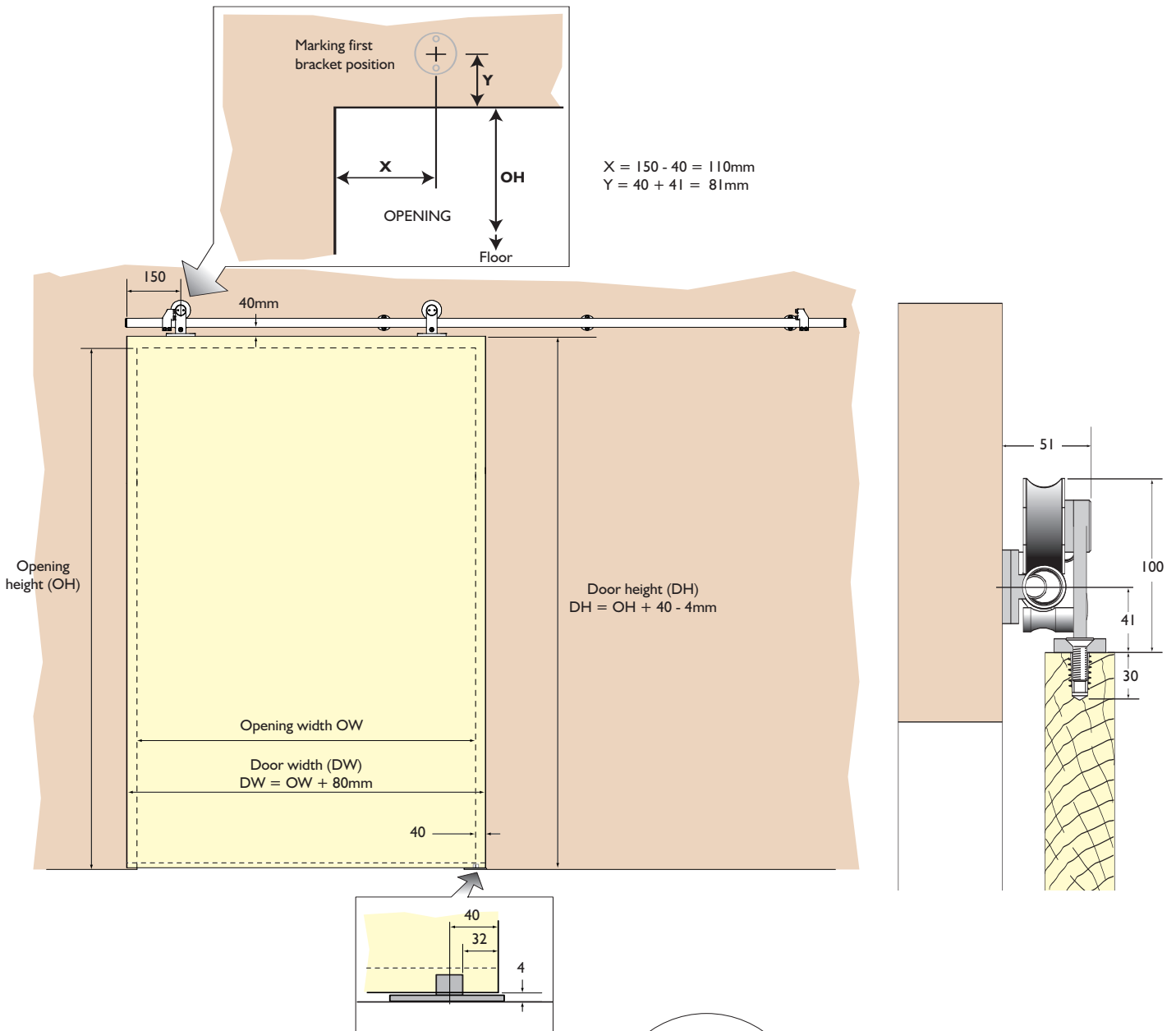

Standard Bar	No. of Fixing Plates / Brackets
2000mm	4
2500mm	5
3000mm	6
3500mm	7
4000mm	8
5000mm	11

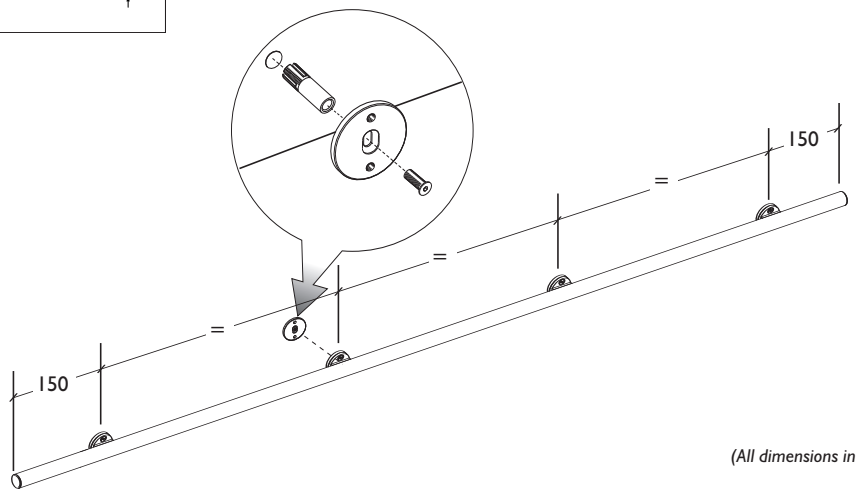

(All dimensions in mm)

HENDERSON

P C Henderson Limited, Durham Road, Bowburn, County Durham DH6 5NG, UK. Web: www.pchenderson.com
 UK Customer Services Department: Tel: +44 (0)191 377 7345 Fax: +44 (0)191 377 3116 Email: sales@pchenderson.com
 Export Department: Tel: +44 (0)191 377 7346 Fax: +44 (0)191 377 0755. Email: international@pchenderson.com.
 For all technical queries email our Technical Department: technical@pchenderson.com