

125 FLUSH PULL

HENDERSON

Fitting Instructions

1. Prepare door panel as shown in Diagram 1.
2. Fit back plate to door using screws provided.
3. Fix front plate into position as shown in Diagram 2.

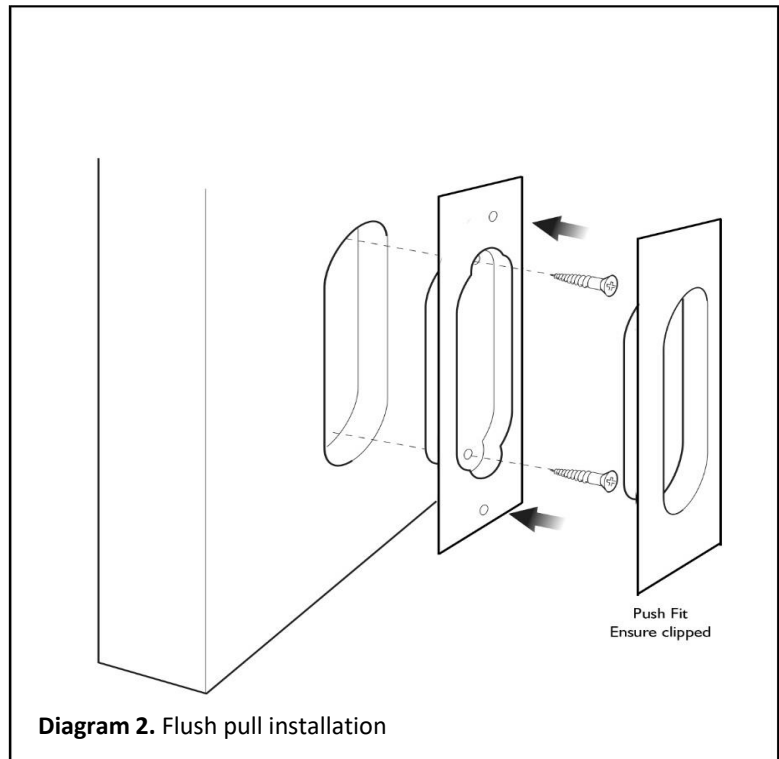
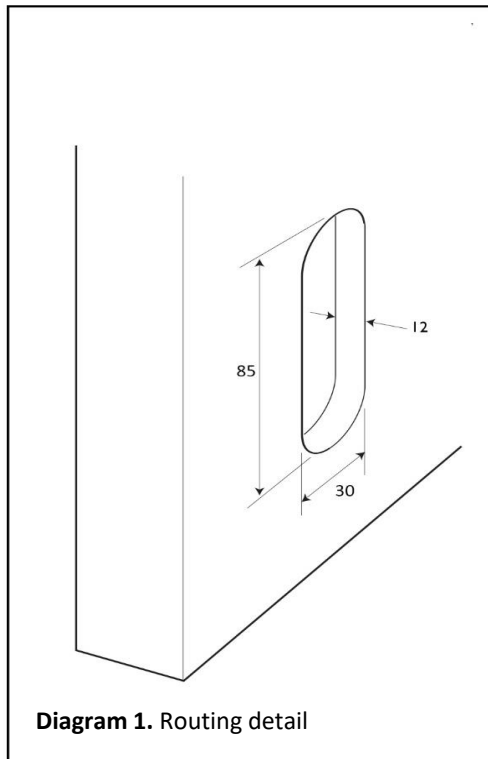

P C Henderson Ltd, Durham Road, Bowburn, Co. Durham, DH6 5NG, UK

UK Sales

t: +44 (0) 191 377 7345

e: sales@pchenderson.com

w: www.pchenderson.com

Export Sales

t: +44 (0) 191 377 7346

e: international@pchenderson.com

w: export.pchenderson.com

Part No. 664873

Level 01

January 2020